

TAP EXTENSION

101 SERIES MACHINE TAP EXTENSION

102 SERIES PIPE EXTENSIONS

MACHINE TAPPING

PIPE npt TAPPING

PART	MACHINE 101	PRICE	PART	MACHNE 101	PRICE	PART	PIPE npt 102	PRICE
1012	#0 -6 x 2"	\$36.32	1104	9/16" x 4"	\$57.76	2014	1/16 NPT x 4"	\$44.92
1014	#0 -6 x 4"	\$37.80	1106	9/16" x 6"	\$60.07	2016	1/16 NPT x 6"	\$47.95
1016	#0 -6 x 6"	\$38.96	1108	9/16" x 8"	\$63.10	2018	1/16 NPT x 8"	\$51.01
1018	#0 -6 x 8"	\$40.18	1110	9/16 x 12" NEW	\$68.84			
1020	#0-6 X 12"	*42.56	1114	5/8" x 4"	\$60.07	2024	1/8 NPT x 4"	\$52.08
1022	#8 x 2"	\$36.32	1116	5/8" x 6"	\$63.10	2026	1/8 NPT x 6"	\$54.84
1024	#8 x 4"	\$37.80	1118	5/8" x 8"	\$65.58	2028	1/8 NPT x 8"	\$57.31
1026	#8 x 6"	\$38.96	1120	5/8" x 12" NEW	\$71.09			
1028	#8 x 8"	\$40.18	1124	11/16" x 4"	\$81.01	2034	1/4 NPT x 4"	\$74.40
1030	#8 x 12"	*42.56	1126	11/16" x 6"	\$88.17	2036	1/4 NPT x 6"	\$79.63
1032	#10 x 2"	\$36.32	1128	11/16" x 8"	\$93.68	2038	1/4 NPT x 8"	\$84.59
1034	#10 x 4"	\$37.80	1130	11/16 x 12"	*106.35			
1036	#10 x 6"	\$38.99	1134	3/4" x 4"	\$82.11	2044	3/8 NPT x 4"	\$95.34
1038	#10 x 8"	\$40.18	1136	3/4" x 6"	\$87.62	2046	3/8 NPT x 6"	\$101.13
1040	#10 X 12"	*42.56	1138	3/4" x 8"	\$93.13	2048	3/8 NPT x 8"	\$107.18
1044	#12 x 4"	\$39.90	1140	3/4" x 12"	*104.12			
1046	#12 x 6"	\$41.67	1144	13/16" x 4"	\$81.01	2054	1/2 NPT x 4"	\$90.37
1048	#12 x 8"	\$43.15	1146	13/16" x 6"	\$94.23	2056	1/2 NPT x 6"	\$95.88
1050	#12 x 12" NEW	\$46.40	1148	13/16" x 8"	\$109.94	2058	1/2 NPT x 8"	\$101.13
1054	1/4" x 4"	\$41.67	1150	13/16"x12" NEW	\$138.87			
1056	1/4" x 6"	\$43.15	1154	7/8" x 4"	\$101.39	2064	3/4 NPT x 4"	\$130.88
1058	1/4" x 8"	\$46.25	1156	7/8" x 6"	\$106.90	2066	3/4 NPT x 6"	\$136.66
1060	1/4 X 12"	*50.83	1158	7/8" x 8"	\$112.97	2068	3/4 NPT x 8"	\$143.27
1064	5/16" x 4"	\$45.25	1160	7/8" x 12"	*124.55			
1066	5/16" x 6"	\$46.74	1164	15/16" x 4"	\$116.28	2074	1" NPT x 4"	\$267.81
1068	5/16" x 8"	\$49.38	1166	15/16" x 6"	\$123.44	2076	1" NPT x 6"	\$286.55
1070	5/16 x 12"	*53.51	1168	15/16" x 8"	\$131.15	2078	1" NPT x 8"	\$308.59
1074	3/8" x 4"	\$46.74	1170	15/16" x 12"	*146.02			
1076	3/8" x 6"	\$49.38	1174	1" x 4"	\$116.28	2094	1 -1/4 NPT x 4"	\$328.67
1078	3/8" x 8"	\$52.08	1176	1" x 6"	\$123.44	2096	1 -1/4 NPT x 6"	\$337.93
1080	3/8 x 12"	*57.42	1178	1" x 8"	\$131.15	2098	1 -1/4 NPT x 8"	\$343.04
1084	7/16" x 4"	\$46.74	1180	1" x 12"	*146.02			
1086	7/16" x 6"	\$49.38	1184	1 -1/8" x 4"	\$147.07	3014	1 -1/2 NPT x 4"	\$358.45
1088	7/16" x 8"	\$52.08	1186	1 -1/8" x 6"	\$152.66	3016	1 -1/2 NPT x 6"	\$367.01
1090	7/16 x 12"	*57.42	1188	1 -1/8" x 8"	\$160.51	3018	1 -1/2 NPT x 8"	\$372.36
1094	1/2" x 4"	\$49.38	1190	1 - 1/8 x 12"	*173.95			
1096	1/2" x 6"	\$52.08	1194	1 -1/4" x 4"	\$267.81	FIND A DISTRIBUTOR		
1098	1/2" x 8"	\$52.52	1196	1 -1/4" x 6"	\$284.83	KEEP IT LOCAL!		
1100	1/2 x 12"	*55.66	1198	1 -1/4" x 8"	\$305.14	Buy our product from your tool Distributor		
			1200	1 -1/4" x 12"	*342.47	OR CALL 1-800-LONGTAP (566-4827)		

12" New Item * BACK-ORDER FOR PRIORITY SERVICE

GUARANTEED IN STOCK SHIPS SAME DAY BY 3PM (PST)



MACHINE SERIES 101 SIZE CHART

STANDARD TAP SIZE	ANSI METRIC	A	B	C	D	E	F	Extension Lengths				
		MAXIMUM EXTENSION DIAMETER	MAXIMUM TAP SHANK ACCEPTED	MAXIMUM TAP SQUARE ACCEPTED	LENGTH OF SMALL SHANK OF EXTENSION	DIAMETER OF SMALL SHANK OF EXTENSION	SQUARE SHANK OF EXTENSION	2"	4"	6"	8"	12"
#0-6	M2.2, M3	.250	.141	0.110			0.191	1012	1014	1016	1018	*1020
# 8	M4	.250	.168	0.131			0.191	1022	1024	1026	1028	*1030
# 10	M5	.250	.194	0.152			0.191	1032	1034	1036	1038	*1040
# 12	COMING SOON!	.312	.220	0.165	1.5	0.220	0.165		1044	1046	1048	1050
1/4"	M6	.375	.255	0.191	1.5	0.255	0.191		1054	1056	1058	*1060
5/16"	M7 & M8	.437	.318	0.238	1.5	0.318	0.238		1064	1066	1068	*1070
3/8"	M10	.500	.381	0.286	1.5	0.381	0.286		1074	1076	1078	*1080
7/16"	COMING SOON!	.500	.323	0.242	1.5	0.323	0.242		1084	1086	1088	*1090
1/2"	M12.5	.500	.367	0.275	1.5	0.367	0.275		1094	1096	1098	*1100
9/16"	M14	.625	.429	0.322	1.5	0.429	0.322		1104	1106	1108	1110
5/8"	M16	.625	.480	0.360	1.5	0.480	0.36		1114	1116	1118	1120
11/16"	M18	.625	.542	0.406	1.5	0.541	0.406		1124	1126	1128	*1130
3/4"	COMING SOON!	.750	.590	0.442	1.5	0.590	0.442		1134	1136	1138	*1140
13/16"	M20	.875	.652	0.489	1.5	0.652	0.489		1144	1146	1148	1150
7/8"	M22	.875	.697	0.523	1.5	0.697	0.523		1154	1156	1158	*1160
15/16"	M24	.875	.760	0.570	1.5	0.760	0.57		1164	1166	1168	*1170
1"	M25	1.000	.800	0.600	1.5	0.800	0.6		1174	1176	1178	*1180
1-1/8"	M27	1.125	.896	0.672	1.5	0.896	0.672		1184	1186	1188	*1190
1-1/4"	M30	1.250	1.021	0.766	1.5	1.021	0.766		1194	1196	1198	*1200

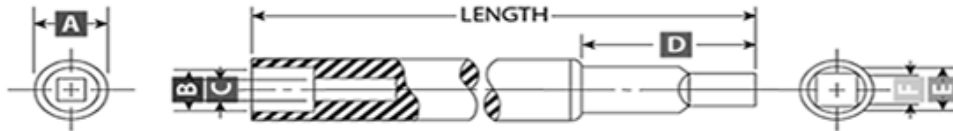

NEED A MODIFICATION OF CUSTOM SIZE?
1-800-566-4827



NO SET SCREWS OR COLLETS NEEDED!

PIPE (NPT) SERIES 102 SIZE CHART

STANDARD TAP SIZE	A	B	C	D	E	EXTENSION LENGTHS		
	MAXIMUM EXTENSION DIAMETER	MAXIMUM TAP SHANK ACCEPTED	MAXIMUM TAP SQUARE ACCEPTED	LENGTH OF SMALL SHANK OF EXTENSION	DIAMETER OF SMALL SHANK OF EXTENSION	4"	6"	8"
						product numbers		
1/16"	.437	.312	.234	1.5	.312	2014	2016	2018
1/8"	.625	.437	.328	1.5	.437	2024	2026	2028
1/4"	.750	.562	.421	1.5	.562	2034	2036	2038
3/8"	.875	.700	.531	1.5	.700	2044	2046	2048
1/2"	.875	.687	.515	1.5	.687	2054	2056	2058
3/4"	1.125	.906	.679	1.5	.906	2064	2066	2068
1"	1.312	1.125	.843	1.5	1.125	2074	2076	2078
1-1/4"	1.500	1.3125	.984	1.5	1.3125	2084	2086	2088
1-1/2"	1.750	1.500	1.125	1.5	1.500	3014	3016	3018